

Earth Tones

Native Plant Nursery & Landscapes

212 Grassy Hill Road

Woodbury, CT 06798

Telephone: (203) 263-6626

Hours: Weds.-Sat. 9 a.m.-4 p.m.

Sun.-Tues. By Appointment

www.earthtonesnatives.com

EarthTones_Info@pm.me

Plant Catalog

2024



Who We Are:

***Earth Tones** is a native plant nursery that offers ferns, grasses, perennials, shrubs, trees, and vines that are native to our local region. We propagate from a native seed source.*

***Earth Tones** also provides landscape design, consulting, installation, and wetlands mitigation services with a focus on environmentally sound practices.*

Earth Tones Nursery is:

- *Pesticide Free*
- *Local Seed Collection*
- *Locally Grown*
- *Pollinator approved*

Table of Contents

Nursery Policies.... 2

Perennials.....3

Aquatics/Bog Plants.....17

Ferns.....18

Grasses.....19

Trees/Shrubs/Vines...21

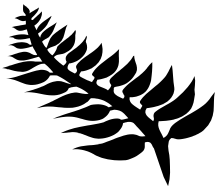

**Indicates Plants Native to
Neighboring States-Not Connecticut*

Plugs: We carry a variety of our perennial and grass plant stock in plug/starter sizes that are perfect when planting a large area. Must purchase a half tray (16 plug) minimum per plant. Plug prices range depending on variety available at the nursery upon request. Current perennial plug pricing ranges from \$4.25-\$4.75 a plug.

Starter Shrubs/Trees: We also carry many of our shrubs, trees, and vines in starter one-quart sizes for \$10.00 each. Shrubs are also sold in the plug size for \$6.50 each. Not all our nursery stock is available in starter sizes. However, if you are looking for a specific plant in the plug or quart size, just ask and we will be happy to check for you! Plant stock changes frequently! We're always adding new plants!

Processing Fee: A 1.5% service charge will be charged on all credit card transactions due to a third party company providing secure and convenient payment service. Valid checks or cash are always welcome and will not be charged these additional fees.

Order Policy: A 20% nonrefundable deposit is required to hold plant orders. Orders will be held for no longer than 1 month, at this point plants will be put back and the deposit will be kept.

Pickups: Large orders (25+ plants) may be pulled ahead of time for pickup at the nursery during our general hours, please give at least 7 days' notice. Either call or email to set up a pickup time. We will help you load up the plants and cover them, bringing a tarp to protect plants in transport is recommended. Tarps available for sale here if you would like to purchase one. If unable to pick up plants on the scheduled pickup date, please notify us to reschedule.

Quotes: Quotes can be made upon request. The quote is based on the plants available as of the date initially quoted and cannot be guaranteed past that day.

Delivery: Fees depend on location and size of an order, please call or email for a delivery quote.

****Plant sizes, prices, and availability subject to change. Please call or email to confirm availability or pricing.**

Perennials

Light Exposure: ○ - Full Sun, ◐ - Part Sun/Part Shade, ● - Full Shade

Latin	Common	Size	Price	Light Exposure	Soil Moisture
<i>Achillea millefolium</i>	Common Yarrow	2 Qt.	\$12.00	○	Dry
<i>Actaea pachypoda</i>	Doll's Eyes Baneberry	2 Qt.	\$22.00	◐-●	Moist to Average
<i>Actaea racemosa</i>	Black Cohosh	1 Gal.	\$30.00	◐-●	Moist to Average
<i>Actaea rubra</i>	Red Baneberry	1 Qt.	\$18.00	◐-●	Moist to Average
<i>Agastache foeniculum</i>	Purple Anise Hyssop	2 Qt.	\$15.00	○	Average to Dry
<i>Ageratina altissima</i>	White Snakeroot	2 Qt.	\$12.00	◐	Average
* <i>Allium cernuum</i>	Nodding Onion	1 Gal.	\$12.00	○-◐	Average
<i>Allium tricoccum</i>	Wild Leek Ramps	1 Qt.	\$14.00	◐-●	Moist to Average
* <i>Amsonia tabernaemontana</i>	Eastern Bluestar	1 Gal.	\$15.00	○-◐	Average
<i>Anaphalis margaritacea</i>	Pearly Everlasting	1 Gal.	\$12.00	○	Average
<i>Anemone canadensis</i>	Canada Windflower	1 Qt.	\$12.00	○-◐	Average to Dry
<i>Anemone virginiana</i>	Tall Windflower	2 Qt.	\$12.00	◐-○	Moist to Average
<i>Angelica atropurpurea</i>	Purple-stemmed Great Angelica	2 Qt.	\$14.00	◐	Moist to Average

Perennials

Light Exposure: ○ - Full Sun, ● - Part Sun/Part Shade, ● - Full Shade

Latin	Common	Size	Price	Light Exposure	Soil Moisture
<i>Antennaria neglecta</i>	Field Pussytoes	1Qt.	\$10.00	●	Average to Dry
<i>Antennaria plantaginifolia</i>	Platain- Leaved Pussytoes	1 Qt.	\$10.00	●	Average to Dry
<i>Apocynum cannabinum</i>	Indian Hemp	2Qt.	\$12.00	○	Average
<i>Aquilegia canadensis</i>	Red Columbine	1Qt. 1Gal.	\$10.00 \$18.00	●	Average
<i>Aralia nudicaulis</i>	Wild Sarsaparilla	1 Qt.	\$10.00	●	Moist to Average
<i>Aralia racemosa</i>	American Spikenard	2 Qt.	\$15.00	●	Moist to Average
<i>Arisaema triphyllum</i>	Jack-in-the- Pulpit	1 Qt.	\$16.00	●	Moist to Average
<i>Asarum canadense</i>	Wild Ginger	1 Qt.	\$16.00	●	Moist to Average
<i>Asclepias incarnata</i>	Swamp Milkweed	1 Gal.	\$18.00	○-●	Moist to Average
<i>Asclepias syriaca</i>	Common Milkweed	1 Gal.	\$18.00	○	Average to Dry
<i>Asclepias tuberosa</i>	Butterflyweed	1 Gal.	\$20.00	○	Average to Dry
<i>Asclepias verticillata</i>	Whorled Milkweed	1 Gal.	\$22.00	○	Average to Dry

Perennials

Light Exposure: ○ - Full Sun, ◐ - Part Sun/Part Shade, ● - Full Shade

Latin	Common	Size	Price	Light Exposure	Soil Moisture
<i>Astragalus canadensis</i>	Canadian Milk Vetch	2 Qt.	\$16.00	○	Average
<i>Baptisia australis</i>	Blue Wild Indigo	1 Gal.	\$14.00	○-◐	Average
<i>Baptisia tinctoria</i>	Wild Indigo	1 Gal.	\$18.00	○-◐	Average to Dry
<i>Boltonia asteroides</i>	Thousand Flower Aster	1 Gal.	\$16.00	○	Average to Dry
<i>Caltha palustris</i>	Marsh Marigold	2 Qt.	\$14.00	○-◐	Moist
<i>Campanula rotundifolia</i>	Bellflower	2 Qt.	\$18.00	○-◐	Average to Dry
<i>Caulophyllum thalictroides</i>	Blue Cohosh	1 Qt.	\$18.00	◐-●	Moist
<i>Chelone glabra</i>	White Turtlehead	2 Qt.	\$15.00	◐	Moist
<i>Chrysogonum virginicum</i>	Golden Star	1 Qt.	\$12.00	◐	Average
<i>Claytonia virginica</i>	Spring Beauty	1 Qt.	\$18.00	◐	Moist to Average
<i>Collinsonia canadensis</i>	Northern Horse Balm	2 Qt.	\$10.00	◐	Moist to Average
<i>Conoclinium coelestinum</i>	Hardy Ageratum	2 Qt.	\$12.00	○-◐	Average
<i>Coreopsis lanceolata</i>	Lance-leaved Tickseed	2 Qt.	\$15.00	○	Average

Perennials

Light Exposure: ○ - Full Sun, ◐ - Part Sun/Part Shade, ● - Full Shade

Latin	Common	Size	Price	Light Exposure	Soil Moisture
<i>Coreopsis rosea</i>	Pink Tickseed	2 Qt.	\$16.00	○-◐	Moist to Average
<i>Coreopsis tripteris</i>	Tall Tickseed	1 Gal.	\$16.00	○	Average to Dry
<i>Coreopsis verticillata</i>	Threadleaf Tickseed	1 Gal.	\$12.00	○	Average to Dry
<i>Desmodium canadense</i>	Showy Tick Trefoil	1 Gal.	\$12.00	○-◐	Average to Dry
<i>Dicentra cucullaria</i>	Dutchman's Breeches	1 Qt.	\$15.00	◐	Moist
<i>Dicentra eximia</i>	Wild Bleeding	1 Qt. 1 Gal.	\$15.00 \$20.00	◐	Average
<i>Doellingeria umbellata</i>	Flat- Topped Aster	2 Qt.	\$10.00	○	Moist
<i>Echinacea pallida</i>	Pale Purple Coneflower	2 Qt.	\$15.00	○	Average
<i>Echinacea purpurea</i>	Purple or White Coneflower	1 Gal.	\$16.00	○-◐	Average
<i>Erigeron pulchellus</i>	Robin-Plantain Fleabane	1 Qt.	\$9.00	○-◐	Moist to Average
<i>Eryngium yuccifolium</i>	Rattlesnake Master	1 Gal.	\$15.00	○	Average to Dry
<i>Erythronium americanum</i>	Yellow Trout Lily	1 Qt.	\$12.00	◐-●	Moist

Perennials

Light Exposure: ○ - Full Sun, ◐ - Part Sun/Part Shade, ● - Full Shade

Latin	Common	Size	Price	Light Exposure	Soil Moisture
<i>Eupatorium hyssopifolium</i>	Hyssop-leaved Boneset	2 Qt.	\$14.00	○-◐	Average to Dry
<i>Eupatorium perfoliatum</i>	Thoroughwort Boneset	1 Gal.	\$15.00	○	Moist to Average
<i>Eurybia divaricata</i>	White Wood Aster	2 Qt.	\$10.00	◐-●	Average to Dry
<i>Eurybia macrophylla</i>	Big-leaved Aster	2 Qt.	\$15.00	◐-●	Average
<i>Euthamia graminifolia</i>	Grass- Leaved Goldenrod	2 Qt.	\$10.00	○	Average to Dry
<i>Eutrochium dubium</i>	Coastal Joe Pye Weed	1 Gal.	\$18.00	○	Moist to Average
<i>Eutrochium fistulosum</i>	Joe Pye Weed	1 Gal.	\$18.00	○	Moist to Average
<i>Eutrochium maculatum</i>	Spotted Joe Pye Weed	1 Gal.	\$18.00	○-◐	Moist to Average
<i>Filipendula rubra</i>	Queen of the Prairie	2 Qt.	\$16.00	○	Moist to Average
<i>Fragaria vesca</i>	Wood Strawberry	1 Qt.	\$9.00	◐	Average
<i>Fragaria virginiana</i>	Common Strawberry	1 Qt.	\$9.00	○-◐	Average to Dry
<i>Gentiana clausa</i>	Bottle Gentian	2 Qt.	\$24.00	◐	Moist

Perennials

Light Exposure: ○ - Full Sun, ◐ - Part Sun/Part Shade, ● - Full Shade

Latin	Common	Size	Price	Light Exposure	Soil Moisture
<i>Geranium maculatum</i>	Spotted Crane's Bill	2 Qt.	\$16.00	◐	Average
<i>Geranium robertianum</i>	Herb Robert	1 Qt.	\$8.00	◐	Average to Dry
<i>Geum rivale</i>	Water Avens	2 Qt.	\$10.00	◐	Moist
<i>Helenium autumnale</i>	Sneezeweed	1 Gal.	\$15.00	○-◐	Moist to Average
<i>Helenium flexuosum</i>	Purplehead Sneezeweed	2 Qt.	\$14.00	○-◐	Moist to Average
<i>Helianthus decapetalus</i>	Thin- leaved Sunflower	1 Gal.	\$15.00	○-◐	Average
<i>Heliopsis helianthoides</i>	Sunflower Everlasting	1 Gal.	\$15.00	○-◐	Average
<i>Heracleum maximum</i>	American Cow Parsnip	2 Qt.	\$18.00	◐	Moist to Average
<i>Heuchera americana</i>	Coral Bells	1 Qt.	\$18.00	◐-●	Average
<i>Hibiscus mocheutos</i>	Swamp Rose Mallow	1 Gal.	\$20.00	○	Moist to Average
<i>Hibiscus mocheutos var. palustris</i>	Pink Swamp Rose Mallow	1 Gal.	\$20.00	○	Moist to Average
<i>Houstonia caerulea</i>	Bluets	1 Qt.	\$9.00	◐	Average to Dry

Perennials

Light Exposure: ○ - Full Sun, ● - Part Sun/Part Shade, ● - Full Shade

Latin	Common	Size	Price	Light Exposure	Soil Moisture
<i>Hypoxis hirsuta</i>	Yellow Stargrass	1 Qt.	\$9.00	●	Average to Dry
<i>Ionactis linariifolia</i>	Stiff- Leaved Aster	1 Qt.	\$15.00	○	Average to Dry
<i>Iris cristata</i>	Dwarf Wood Iris	1 Qt.	\$12.00	●	Moist to Average
<i>Iris versicolor</i>	Blue Flag Iris	1 Gal.	\$14.00	○-●	Moist
* <i>Jeffersonia diphylla</i>	Twinleaf	1 Qt.	\$20.00	●-●	Moist
<i>Krigia virginica</i>	Dwarf Dandelion	1 Qt.	\$7.50	○-●	Average to Dry
<i>Lespedeza capitata</i>	Round- Headed Bush Clover	2 Qt.	\$12.50	○	Average to Dry
<i>Lespedeza hirta</i>	Hairy Bush Clover	2 Qt.	\$12.50	○	Average to Dry
* <i>Liatris liguistylis</i>	Meadow Blazing Star	1 Gal.	\$16.50	○	Average to Dry
<i>Liatris novae-angliae</i>	New England Blazing Star	1 Gal.	\$20.0	○	Average to Dry
<i>Liatris spicata</i>	Blazing Star	2 Qt.	\$15.00	○	Moist- Average
<i>Lilium canadense</i>	Canada Lily	2 Qt.	\$28.00	○-●	Moist to Average
<i>Lobelia cardinalis</i>	Red Cardinal Flower	2 Qt.	\$15.00	○-●	Moist to Average

Perennials

Light Exposure: ○ - Full Sun, ◐ - Part Sun/Part Shade, ● - Full Shade

Latin	Common	Size	Price	Light Exposure	Soil Moisture
<i>Lobelia siphilitica</i>	Great Blue Lobelia	2 Qt.	\$15.00	○-◐	Moist to Average
<i>Lobelia spicata</i>	Palespike Lobelia	2 Qt.	\$15.00	○	Average- Dry
<i>Lysimachia cilata</i>	Fringed Loosestrife	2 Qt.	\$10.00	◐	Moist to Average
<i>Maianthemum canadense</i>	Canada Mayflower	1 Qt.	\$8.00	◐-●	Average
<i>Maianthemum racemosum</i>	False Solomon's Seal	2 Qt.	\$16.00	◐-●	Average to Dry
* <i>Mertensia virginica</i>	Virginia Bluebells	2 Qt.	\$16.00	◐	Average
<i>Mimulus ringens</i>	Allegheny Monkey Flower	2 Qt.	\$12.00	○	Moist to Average
<i>Mitchella repens</i>	Partridgeberry	1 Qt.	\$15.00	◐	Average
<i>Mitella diphylla</i>	Fairy Cup	2 Qt.	\$15.00	◐	Average
<i>Monarda didyma</i>	Bee Balm Oswega Tea	2 Qt.	\$14.00	○-◐	Moist to Average
<i>Monarda fistulosa</i>	Purple Wild Bergamot	2 Qt.	\$14.00	○	Average to Dry
<i>Monarda punctata</i>	Dotted Mint	1 Qt.	\$12.00	○	Average to Dry
<i>Oenothera fruticosa</i>	Sundrops	2 Qt.	\$14.00	○	Average to Dry

Perennials

Light Exposure: ○ - Full Sun, ● - Part Sun/Part Shade, ● - Full Shade

Latin	Common	Size	Price	Light Exposure	Soil Moisture
<i>Oenothera perennis</i>	Small Sundrops	2 Qt.	\$14.00	○	Average to Dry
<i>Opuntia humifusa</i>	Prickly Pear Cactus (Yellow Flower)	1 Qt.	\$24.00	○	Dry
<i>Opuntia cespitosa</i>	Prickly Pear Cactus (Red Center Flower)	1 Qt.	\$24.00	○	Dry
<i>Packera aurea</i>	Golden Ragwort	2 Qt.	\$15.00	●	Moist to Average
<i>Packera obovata</i>	Round- Leaf Ragwort	1 Qt.	\$15.00	●	Average
<i>Penstemon digitalis</i>	Beardtongue	2 Qt.	\$14.00	○-●	Average
<i>Penstemon hirsutus</i>	Hairy Beardtongue	2 Qt.	\$15.00	○-●	Average
<i>Penstemon pallidus</i>	Pale Beardtongue	2 Qt.	\$14.00	○-●	Average
<i>Phlox divaricata</i>	Wood Phlox	2 Qt.	\$12.00	●	Average
<i>Phlox maculata</i>	Wild Sweet William	2 Qt.	\$12.00	○-●	Average
<i>Phlox paniculata</i>	Garden Phlox	2 Qt.	\$12.00	○-●	Average
<i>Phlox subulata</i>	Creeping Phlox	1 Qt.	\$10.00	○	Average to Dry
<i>Physostegia virginiana</i>	Obedient Plant	2 Qt.	\$12.00	○-●	Average to Dry

Perennials

Light Exposure: ○ - Full Sun, ◐ - Part Sun/Part Shade, ● - Full Shade

Latin	Common	Size	Price	Light Exposure	Soil Moisture
<i>Podophyllum peltatum</i>	May Apple	2 Qt.	\$18.00	◐-●	Moist to Average
<i>Polemonium reptans</i>	Jacob's Ladder	2 Qt.	\$12.00	◐	Average
<i>Polygonatum biflorum</i>	Wild Solomon's Seal	2 Qt.	\$15.00	◐-●	Average
<i>Polygonatum biflorum var. commutatum</i>	Giant Solomon's Seal	1 Gal.	\$24.00	◐-●	Moist to Average
<i>Pycnanthemum incanum</i>	Hoary Mountain Mint	2 Qt.	\$14.00	○	Average to Dry
<i>Pycnanthemum muticum</i>	Mountain Mint	2 Qt.	\$14.00	○-◐	Average to Dry
<i>Pycnanthemum tenuifolium</i>	Narrow- Leaved Mountain Mint	2 Qt.	\$14.00	○	Average to Dry
<i>Rudbeckia fulgida</i>	Black-Eyed Susan	2 Qt.	\$12.50	○-◐	Average
<i>Rudbeckia hirta</i>	Black-Eyed Susan biennial	1 Qt.	\$10.00	○-◐	Average to Dry
<i>Rudbeckia laciniata</i>	Cut- Leaf Coneflower	1 Gal.	\$16.00	○-◐	Moist to Average
<i>Rudbeckia triloba</i>	Brown- Eyed Susan	1 Gal.	\$15.00	○	Average to Dry
<i>Salvia lyrata</i>	Lyre- Leaved Sage	1 Qt.	\$12.00	○	Average to Dry

Perennials

Light Exposure: ○ - Full Sun, ● - Part Sun/Part Shade, ● - Full Shade

Latin	Common	Size	Price	Light Exposure	Soil Moisture
<i>Sanguinaria canadensis</i>	Bloodroot	1 Qt.	\$25.00	●	Average
<i>Scutellaria integrifolia</i>	Entire- Leaved Skullcap	2 Qt.	\$15.00	●	Average to Dry
<i>Sedum ternatum</i>	Wild Stone Crop	1 Qt.	\$9.00	●	Average
<i>Senna hebecarpa</i>	Wild Senna	1 Gal.	\$20.00	○	Average to Dry
<i>Silene caroliniana</i>	Wild Pink	2 Qt.	\$16.00	○-●	Average to Dry
<i>Silene virginica</i>	Fire Pink Silene	2 Qt.	\$16.00	○-●	Average
<i>Sisyrinchium angustifolium</i>	Blue-Eyed Grass	2 Qt.	\$15.00	●	Moist to Average
<i>Sium suave</i>	Water Parsnip	2 Qt.	\$10.00	○	Moist
<i>Solidago bicolor</i>	Silverrod	2 Qt.	\$12.00	○-●	Average to Dry
<i>Solidago caesia</i>	Blue- stemmed Goldenrod	2 Qt.	\$14.00	●	Average to Dry
<i>Solidago erecta</i>	Slender Goldenrod	2 Qt.	\$12.00	○-●	Average to Dry
<i>Solidago flexicaulis</i>	Zigzag Goldenrod	2 Qt.	\$14.00	●	Average to Dry
<i>Solidago juncea</i>	Early Goldenrod	2 Qt.	\$12.00	○	Average to Dry

Perennials

Light Exposure: ○ - Full Sun, ● - Part Sun/Part Shade, ● - Full Shade

Latin	Common	Size	Price	Light Exposure	Soil Moisture
<i>Solidago nemoralis</i>	Gray Goldenrod	2 Qt.	\$14.00	○-●	Average to Dry
<i>Solidago patula</i>	Rough Leaved Goldenrod	2 Qt.	\$12.00	●	Moist to Average
<i>Solidago sempervirens</i>	Seaside Goldenrod	1 Gal.	\$16.00	○	Dry
<i>Solidago speciosa</i>	Showy Goldenrod	2 Qt.	\$16.00	○-●	Average
<i>Solidago uliginosa</i>	Swamp Goldenrod	1 Gal.	\$12.00	○	Moist
<i>Stylophorum diphyllum</i>	Celandine Poppy	2 Qt.	\$18.00	●	Average
<i>Symphyotrichum cordifolium</i>	Blue Wood Aster	2 Qt.	\$12.00	●	Average
<i>Symphyotrichum laeve</i>	Smooth Aster	2 Qt.	\$15.00	○	Average to Dry
<i>Symphyotrichum laterifolium</i>	Calico Aster	2 Qt.	\$12.00	○-●	Average to Dry
<i>Symphyotrichum novae-angliae</i>	New England Aster	1 Gal.	\$16.00	○-●	Moist to Average
<i>Symphyotrichum novae-belgii</i>	New York Aster	2 Qt.	\$16.00	○	Moist to Average
<i>Symphyotrichum patens</i>	Spreading Aster	2 Qt.	\$15.00	○	Average to Dry

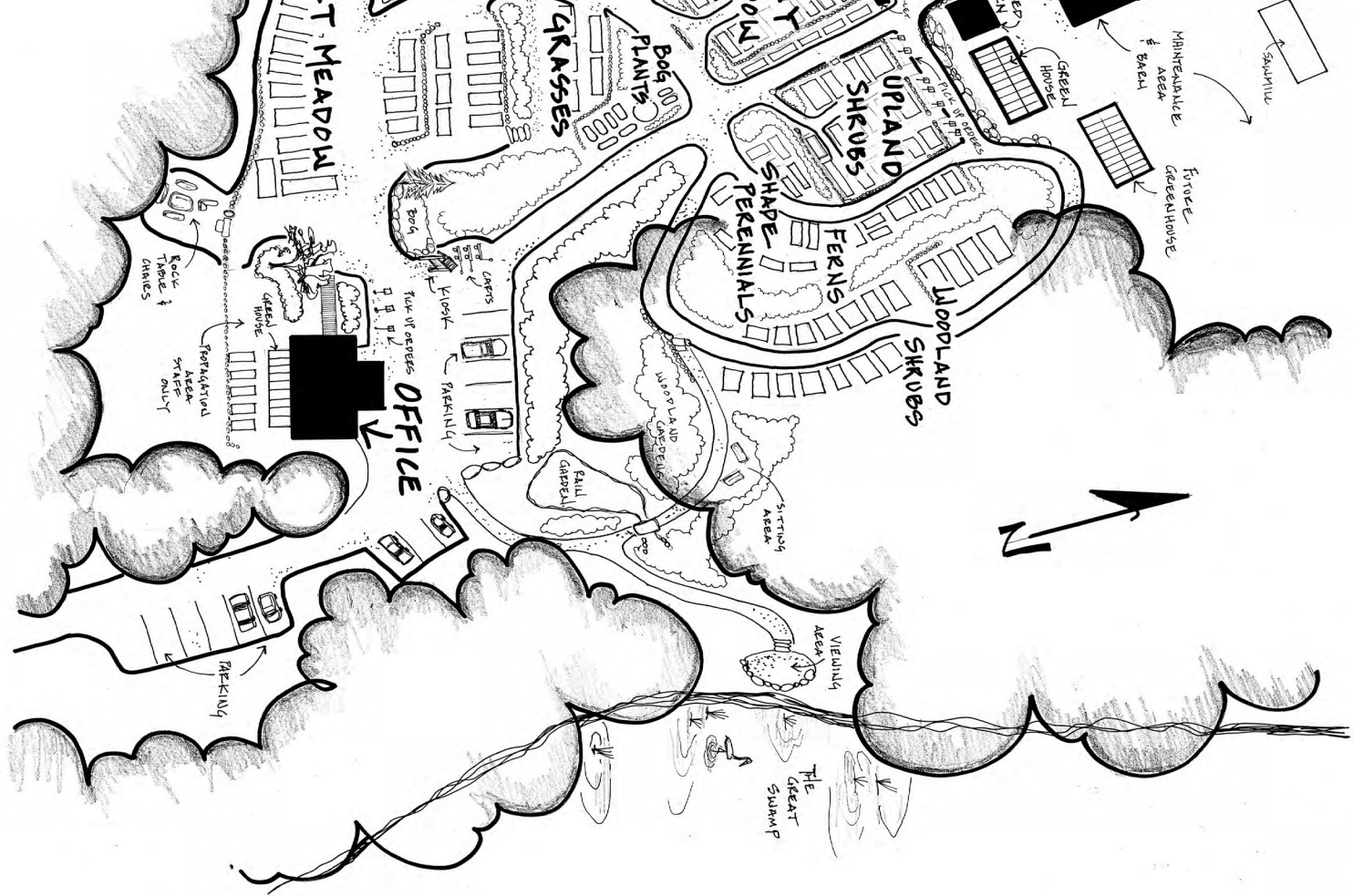

Perennials

Light Exposure: ○ - Full Sun, ● - Part Sun/Part Shade, ● - Full Shade

Latin	Common	Size	Price	Light Exposure	Soil Moisture
<i>Symphyotrichum racemosum</i>	Smooth White Oldfield Aster	2 Qt.	\$10.00	○	Average to Dry
<i>Symplocarpus foetidus</i>	Skunk Cabbage	1 Qt.	\$9.00	●	Moist
<i>Tephrosia virginiana</i>	Wild Goat's Rue	2 Qt.	\$18.00	○	Average to Dry
<i>Teucrium canadense</i>	Germander Wild Sage	2 Qt.	\$10.00	●	Moist to Average
<i>Thalictrum dioicum</i>	Early Meadow Rue	2 Qt.	\$18.00	●	Moist
<i>Thalictrum pubscens</i>	Meadow Rue	2 Qt.	\$15.00	●	Moist to Average
<i>Thalictrum thalictroides</i>	Rue Anemone	1 Qt.	\$15.00	●	Average
<i>Tiarella cordifolia</i>	Foam Flower	1 Qt.	\$12.00	●	Moist to Average
<i>Tradescantia virginiana</i>	Spiderwort	1 Gal.	\$14.00	○-●	Average to Dry
<i>Trillium erectum</i>	Purple Trillium	1 Qt.	\$24.00	●	Moist
<i>Trillium grandiflorum</i>	White Trillium	1 Qt.	\$24.00	●	Average
<i>Verbena hastata</i>	Blue Vervain	2 Qt.	\$14.00	○	Moist to Average
<i>Vernonia noveboracensis</i>	New York Ironweed	2 Qt.	\$15.00	○	Moist to Average

Perennials

Light Exposure: ○ - Full Sun, ● - Part Sun/Part Shade, ● - Full Shade

Latin	Common	Size	Price	Light Exposure	Soil Moisture
<i>Veronicastrum virginicum</i>	Culver's Root	2 Qt.	\$15.00	○-●	Moist to Average
<i>Viola sagittata</i>	Ovate- leaved Violet	1 Qt.	\$9.00	○-●	Average to Dry
<i>Yucca filamentosa</i>	Yucca	1 Gal.	\$15.00	○	Average to Dry
<i>Zizia aurea</i>	Golden Alexander	2 Qt.	\$14.00	●	Moist to Average

Notes

Aquatic/Bog**Light Exposure:** ○ - Full Sun, ◐ - Part Sun/Part Shade, ● - Full Shade

Latin	Common	Size	Price	Light Exposure	Soil Moisture
<i>Calla palustris</i>	Wild Calla	Bare Root	\$15.00	○	Pond Open Water
<i>Drosera intermedia</i>	Spatulate- leaved Sundew	Plug	\$15.00	○	Bog
<i>Drosera rotundifolia</i>	Round- leaved Sundew	Plug	\$18.00	○	Bog
<i>Hypericum boreale</i>	Northern St. John's Wort	Plug	\$8.00	○	Pond edges and Bogs
<i>Lycopus uniflorus</i>	Northern Water-horehound	Plug	\$8.00	○	Edge of shores And wet meadows
<i>Nuphar variegata</i>	Pond Lily	Bare Root	\$15.00	○	Pond Open Water
<i>Sagittaria latifolia</i>	Big Leaved Arrowhead	1 Qt.	\$8.00	○	Edge of Ponds
<i>Sarracenia purpurea</i>	Purple Pitcher Plant	Plug BRoot	\$15 and up	○-◐	Bog
<i>Sphagnum spp.</i>	Sphagnum spp.	1 Bowl	\$25.00	○-●	Consistently moist Bog to Woods
<i>Triadenum (Hypericum) virginicum</i>	Marsh St. John's	Plug 1Qt.	\$8.00 \$12.00	○	Bog
<i>Viola lanceolata</i>	Bog Violet	Plug	\$8.00	○	Bog
<i>Xyris spp.</i>	Yellow Eyed Grass	Plug	\$9.00	○	Bog

Ferns

Light Exposure: ○ - Full Sun, ◐ - Part Sun/Part Shade, ● - Full Shade

Latin	Common	Size	Price	Light Exposure	Soil Moisture
<i>Adiantum pedatum</i>	Maidenhair Fern	1 Gal.	\$18.00	◐-●	Moist to Average
<i>Athyrium (filix- femina) angustum</i>	Lady Fern	1 Gal.	\$18.00	◐	Moist to Average
<i>Dennstaedtia punctilobula</i>	Hay-Scented Fern	1 Gal.	\$18.00	○-◐	Dry to Average
<i>Dryopteris goldiana</i>	Goldie's Wood Fern	1 Gal.	\$18.00	◐	Moist
<i>Dryopteris marginalis</i>	Marginal Shield Fern	1 Gal.	\$18.00	◐	Moist to Average
<i>Matteuccia struthiopteris</i>	Ostrich Fern	1 Gal.	\$18.00	◐	Moist to Average
<i>Onoclea sensibilis</i>	Sensitive Fern	1 Gal.	\$18.00	◐	Moist
<i>Osmundastrum cinnamomeum</i>	Cinnamon Fern	1 Gal.	\$18.00	◐	Moist
<i>Osmunda claytoniana</i>	Interrupted Fern	1 Gal.	\$18.00	◐-●	Moist
<i>Osmunda regalis</i>	Royal Fern	1 Gal.	\$18.00	◐-●	Moist
<i>Polypodium virginianum (vulgare)</i>	Common Polypody	1 Gal.	\$18.00	●	Average to Dry (lithophyte)
<i>Polystichum acrostichoides</i>	Christmas Fern	1 Gal.	\$18.00	◐	Moist to Average

Grasses & Sedges

Light Exposure: ○ - Full Sun, ◐ - Part Sun/Part Shade, ● - Full Shade

Latin	Common	Size	Price	Light Exposure	Soil Moisture
<i>Acorus americana</i>	Sweetflag	2 Qt.	\$15.00	○	Moist
<i>Andropogon gerardii</i>	Big Bluestem	1 Gal.	\$15.00	○	Average to Dry
<i>Carex annectens</i>	Yellow Fruited Sedge	2 Qt.	\$15.00	◐	Moist
<i>Carex appalachia</i>	Appalachian Sedge	1 Qt.	\$15.00	◐-●	Average to Dry
<i>Carex arctata</i>	Drooping Woodland Sedge	2 Qt.	\$15.00	◐	Average
<i>Carex crinita</i>	Fringed Sedge	2 Qt.	\$15.00	○-◐	Moist
<i>Carex disperma</i>	Soft Leaved Sedge	2 Qt.	\$15.00	◐	Average
<i>Carex grayii</i>	Gray Sedge	2 Qt.	\$15.00	○-◐	Moist
<i>Carex intumescens</i>	Greater Bladder Sedge	2 Qt.	\$15.00	○-◐	Moist
<i>Carex laxiculmis</i>	Spreading Sedge	2 Qt.	\$15.00	◐	Average
<i>Carex lurida</i>	Lurid Sedge	2 Qt.	\$15.00	○-◐	Moist to Average
<i>Carex pensylvanica</i>	Pennsylvania Sedge	1 Qt. 1 Gal.	\$10.00 \$20.00	○-◐	Average to Dry
<i>Carex plantaginea</i>	Plantain- leaved Sedge	2 Qt.	\$15.00	◐-●	Moist

Grasses & Sedges

Light Exposure: ○ - Full Sun, ◐ - Part Sun/Part Shade, ● - Full Shade

Latin	Common	Size	Price	Light Exposure	Soil Moisture
<i>Carex sprengelii</i>	Long Beaked Sedge	2 Qt.	\$15.00	◐	Moist
<i>Carex stipata</i>	Awl Fruited	2 Qt.	\$15.00	○-◐	Moist
<i>Carex stricta</i>	Tussock Sedge	2 Qt.	\$15.00	○-◐	Moist
<i>Eragrostis spectabilis</i>	Purple Love Grass	1 Gal.	\$15.00	○	Dry
<i>Juncus effusus</i>	Soft Rush	2 Qt.	\$15.00	○-◐	Moist to Average
<i>Juncus tenuis</i>	Path Rush	1 Qt.	\$10.00	○-◐	Average to Dry
<i>Luzula multiflora</i>	Woodrush	1 Qt.	\$9.00	◐	Average to Dry
<i>Panicum virgatum</i>	Tall Panic Grass Switch Grass	1 Gal.	\$16.00	○-◐	Average to Dry
<i>Schizachyrium scoparium</i>	Little Bluestem	1 Gal.	\$16.00	○	Average to Dry
<i>Scirpus pendulus</i>	Rufous Bulrush	2 Qt.	\$15.00	◐	Moist
<i>Sorghastrum nutans</i>	Indian Grass	1 Gal.	\$16.00	○	Average to Dry
<i>Spartina pectinata</i>	Prairie Cordgrass	1 Gal.	\$15.00	○	Moist to Average
<i>Sporobolus heterolepis</i>	Northern Dropseed	1 Gal.	\$15.00	○	Average to Dry
<i>Tridens flavus</i>	Purple- top Tridens	1 Gal.	\$16.00	○	Average

Trees/Shrubs/Vines*Light Exposure:* ○ - Full Sun, ◐ - Part Sun/Part Shade, ● - Full Shade

Latin	Common	Size	Price	Light Exposure	Soil Moisture
<i>Acer negundo</i>	Boxed Elder	1 Gal. 5 Gal.	\$20.00 \$65.00	○	Moist to Average
<i>Acer pensylvanicum</i>	Striped Maple	1 Gal. 3 Gal.	\$30.00 \$50.00	◐	Average
<i>Acer rubrum</i>	Red Maple	1 Gal. 3 Gal.	\$20.00 \$40.00	◐	Moist to Average
<i>Acer saccharinum</i>	Silver Maple	1 Gal. 3 Gal.	\$20.00 \$40.00	○-◐	Moist
<i>Acer saccharum</i>	Sugar Maple	1 Gal. 5 Gal.	\$25.00 \$50.00	◐	Moist to Average
<i>Acer incana</i>	Speckled Alder	1 Gal. 3 Gal.	\$20.00 \$40.00	○-◐	Moist to Average
<i>Amelanchier canadensis</i>	Serviceberry	1 Gal. 3 Gal.	\$25.00 \$52.00	○-◐	Moist to Average
<i>Amelanchier laevis</i>	Allegheny Serviceberry	1 Gal.	\$25.00	○-◐	Moist to Average
<i>Amelanchier spicata</i>	Dwarf Serviceberry	1 Gal.	\$25.00	○	Moist to Average
<i>Arctostaphylos uva-ursi</i>	Bearberry Kinickinick	1 Gal.	\$35.00	○	Dry
<i>Aronia arbutifolia</i>	Red Chokeberry	1 Gal. 5 Gal.	\$25.00 \$65.00	○-◐	Moist to Average
<i>Aronia melanocarpa</i>	Black Chokeberry	1 Gal. 3 Gal.	\$25.00 \$45.00	○-◐	Moist to Average

Trees/Shrubs/Vines*Light Exposure:* ○ - Full Sun, ◐ - Part Sun/Part Shade, ● - Full Shade

Latin	Common	Size	Price	Light Exposure	Soil Moisture
<i>Asimina triloba</i>	Pawpaw	1 Gal. 3 Gal.	\$25.00 \$55.00	○-◐	Moist to Average
<i>Benthamidia (Cornus) florida</i>	Flowering Dogwood	1 Gal. 3 Gal.	\$30.00 \$75.00	○-◐	Average
<i>Betula alleghaniensis</i>	Yellow Birch	1 Gal. 5 Gal.	\$20.00 \$55.00	○-◐	Moist to Average
<i>Betula papyrifera</i>	Paper Birch	1 Gal. 5 Gal.	\$25.00 \$85.00	○	Moist to Average
<i>Betula populifolia</i>	Gray Birch	1 Gal. 5 Gal.	\$25.00 \$85.00	○	Average to Dry
<i>Carpinus caroliniana</i>	Ironwood Blue Beech	1 Gal. 5 Gal. 7 Gal.	\$30.00 \$75.00 \$95.00	◐-●	Moist to Average
<i>Carya ovata</i>	Shagbark Hickory	1 Gal.	\$25.00	○-◐	Average to Dry
<i>Ceanothus americanus</i>	New Jersey Tea	1 Gal. 3 Gal.	\$25.00 \$48.00	○-◐	Average to Dry
<i>Celtis occidentalis</i>	Hackberry	1 Gal. 3 Gal.	\$25.00 \$55.00	○-◐	Moist
<i>Cephalanthus occidentalis</i>	Buttonbush	1 Gal. 3 Gal.	\$25.00 \$35.00	○-◐	Moist
<i>Cercis canadensis</i>	Eastern Redbud	1 Gal. 3 Gal.	\$25.00 \$45.00	◐-○	Average
<i>Chamaecyparis thyoides</i>	Atlantic White Cedar	1 Gal. 5 Gal.	\$25.00 \$55.00	○	Moist

Trees/Shrubs/Vines*Light Exposure:* ○ - Full Sun, ◐ - Part Sun/Part Shade, ● - Full Shade

Latin	Common	Size	Price	Light Exposure	Soil Moisture
<i>Chamaedaphne calyculata</i>	Leatherleaf	1 Gal. 3 Gal.	\$32.00 \$45.00	○-◐	Moist
<i>Chionanthus virginicus</i>	Fringe Tree	5 Gal.	\$75.00	○-◐	Moist to Average
<i>Clematis virginiana</i>	Virgin's Bower	1 Gal.	\$18.00	◐-○	Moist to Average
<i>Clethra alnifolia</i>	Summersweet	1 Gal. 3 Gal.	\$25.00 \$55.00	○-◐	Moist to Average
<i>Comptonia peregrina</i>	Sweetfern	1 Gal.	\$30.00	○-◐	Average to Dry
<i>Corylus americana</i>	American Hazelnut	1 Gal. 3 Gal.	\$25.00 \$45.00	◐-○	Average
<i>Corylus cornuta</i>	Beaked Hazelnut	1 Gal. 3 Gal.	\$25.00 \$45.00	◐	Moist to Average
<i>Dasiphora floribunda</i> (<i>Potentilla fruticosa</i>)	Yellow Cinquefoil	1 Gal.	\$25.00	○-◐	Average
<i>Diervilla lonicera</i>	Northern Bush Honeysuckle	1 Gal.	\$25.00	◐	Moist to Average
<i>Diospyros virginiana</i>	Persimmon	1 Gal. 5 Gal.	\$25.00 \$85.00	○-◐	Moist to Average
<i>Gaultheria procumbens</i>	Wintergreen	1 Qt.	\$10.00	◐-●	Moist to Average
<i>Hamamelis virginiana</i>	Witchhazel	1 Gal. 5 Gal.	\$30.00 \$95.00	◐	Moist to Average

Trees/Shrubs/Vines*Light Exposure:* ○ - Full Sun, ◐ - Part Sun/Part Shade, ● - Full Shade

Latin	Common	Size	Price	Light Exposure	Soil Moisture
<i>Hydrangea arborescens</i>	Wild Hydrangea	1 Gal.	\$25.00	◐	Average
<i>Hypericum prolificum</i>	Shrubby St. John's Wort	1 Gal. 3 Gal.	\$25.00 \$35.00	○-◐	Moist to Dry
<i>Ilex glabra 'Shamrock'</i>	Dwarf Inkberry		Call for Price	○	Average
<i>Ilex opaca</i>	American Holly	5 Gal.	\$100.00	○-◐	Average
<i>Ilex verticillata</i>	Winterberry	1 Gal. 3 Gal.	\$25.00 \$50.00	○-◐	Moist to Average
<i>Juglans nigra</i>	Black Walnut	3 Gal.	\$45.00	○	Moist to Average
<i>Juniperus communis</i>	Common Juniper	1 Gal. 3 Gal.	\$25.00 \$40.00	○-◐	Average to Dry
<i>Juniperus virginiana</i>	Eastern Red Cedar	1 Gal. 3 Gal.	\$30.00 \$45.00	○	Average to Dry
<i>Kalmia angustifolia</i>	Sheep Laurel	Gal.	\$55.00	◐	Moist
<i>Kalmia latifolia</i>	Mountain Laurel		Call for Price	◐	Average
<i>Larix laricina</i>	Eastern Larch	3 Gal. 7 Gal.	\$60.00 \$95.00	○	Moist to Average
<i>*Leucothoe fontanesiana</i>	Drooping Fetterbush		Call for Price	◐	Moist to Average

Trees/Shrubs/Vines*Light Exposure:* ○ - Full Sun, ◐ - Part Sun/Part Shade, ● - Full Shade

Latin	Common	Size	Price	Light Exposure	Soil Moisture
<i>Lindera benzoin</i>	Spicebush	1 Gal. 3 Gal.	\$25.00 \$40.00	◐-●	Moist to Average
<i>Lonicera dioica</i>	Wild Honeysuckle	1 Gal.	\$25.00	◐	Average to Dry
<i>Lonicera sempervirens</i>	Trumpet Honeysuckle	1 Gal.	\$25.00	○-◐	Average
<i>Lyonia ligustrina</i>	Maleberry	1 Gal. 3 Gal.	\$20.00 \$35.00	◐	Moist
<i>Magnolia virginiana</i>	Sweet Bay Magnolia	1 Gal. 7 Gal.	\$25.00 \$125.00	○-◐	Moist to Average
<i>Morella caroliniensis</i>	Northern Bayberry	1 Gal. 3 Gal.	\$25.00 \$50.00	○	Average to Dry
<i>Myrica gale</i>	Sweetgale	5 Gal.	\$55.00	○	Moist
<i>Nyssa sylvatica</i>	Black Gum	1 Gal. 3 Gal.	\$38.00 \$50.00	○-◐	Moist
<i>Ostrya virginiana</i>	Ironwood	1 Gal. 5 Gal.	\$25.00 \$70.00	◐	Average to Dry
<i>Parthenocissus quinquefolia</i>	Virginia Creeper	1 Gal.	\$15.00	◐	Average
<i>Physocarpus opulifolius</i>	Green Ninebark	1 Gal. 3 Gal.	\$28.00 \$55.00	○-◐	Average
<i>Picea glauca</i>	White Spruce	5 Gal.	\$80.00	○-◐	Average

Trees/Shrubs/Vines*Light Exposure:* ○ - Full Sun, ◐ - Part Sun/Part Shade, ● - Full Shade

Latin	Common	Size	Price	Light Exposure	Soil Moisture
<i>Picea mariana</i>	Black Spruce	5 Gal.	\$85.00	○-◐	Moist to Average
<i>Pinus rigida</i>	Pitch Pine	7 Gal.	\$80.00	○	Average to Dry
<i>Pinus strobus</i>	White Pine	1 Gal.	\$25.00	○-◐	Moist to Average
<i>Platanus occidentalis</i>	Sycamore	1 Gal. 5 Gal.	\$25.00 \$55.00	○	Moist to Average
<i>Prunus maritima</i>	Beach Plum	1 Gal. 3 Gal.	\$25.00 \$50.00	○	Average to Dry
<i>Prunus serotina</i>	Wild Cherry	1 Gal. 5 Gal.	\$25.00 \$65.00	○	Average
<i>Prunus virginiana</i>	Chokecherry	1 Gal. 3 Gal.	\$25.00 \$40.00	○-◐	Moist to Average
<i>Quercus alba</i>	White Oak	1 Gal. 5 Gal.	\$25.00 \$65.00	○	Average to Dry
<i>Quercus bicolor</i>	Swamp White Oak	1 Gal. 5 Gal. 7 Gal.	\$20.00 \$45.00 \$75.00	○-◐	Moist to Average
<i>Quercus coccinea</i>	Scarlet Oak	1 Gal.	\$20.00	○-◐	Average to Dry
<i>Quercus ilicifolia</i>	Scrub Oak	1 Gal. 5 Gal.	\$30.00 \$50.00	○-◐	Average to Dry
<i>Quercus rubra</i>	Northern Red Oak	1 Gal. 3 Gal.	\$20.00 \$35.00	○	Average

Trees/Shrubs/Vines*Light Exposure:* ○ - Full Sun, ◐ - Part Sun/Part Shade, ● - Full Shade

Latin	Common	Size	Price	Light Exposure	Soil Moisture
<i>Rhododendron maximum</i>	Rosebay Rhododendron		Call for Quote	◐	Moist
<i>Rhododendron viscosum</i>	Swamp Azalea	1 Gal. 5 Gal.	\$20.00 \$75.00	◐	Moist to Average
<i>Rhus aromatica</i>	Fragrant Sumac	1 Gal. 3 Gal.	\$25.00 \$55.00	○	Average to Dry
<i>Rhus copallinum</i>	Shining Sumac	1 Gal. 3 Gal.	\$20.00 \$45.00	○-◐	Moist to Average
<i>Rhus glabra</i>	Smooth Sumac	1 Gal. 3 Gal.	\$25.00 \$40.00	○-◐	Average to Dry
<i>Rhus hirta</i>	Staghorn Sumac	1 Gal. 3 Gal.	\$20.00 \$40.00	○	Average to Dry
<i>Ribes americanum</i>	Black Currant	1 Gal. 3 Gal.	\$25.00 \$45.00	◐	Moist to Average
<i>Rosa carolina</i>	Carolina Rose	1 Gal.	\$25.00	○	Average to Dry
<i>Rosa palustris</i>	Swamp Rose	1 Gal. 3 Gal.	\$25.00 \$35.00	○-◐	Moist to Average
<i>Rosa virginiana</i>	Virginia Rose	1 Gal.	\$25.00	○	Average to Dry
<i>Rubus alleghaniensis</i>	Common Blackberry	1 Gal.	\$20.00	◐	Average
<i>Rubus occidentalis</i>	Black Raspberry	1 Gal.	\$20.00	◐	Average

Trees/Shrubs/Vines**Light Exposure:** ○ - Full Sun, ◐ - Part Sun/Part Shade, ● - Full Shade

Latin	Common	Size	Price	Light Exposure	Soil Moisture
<i>Rubus odoratus</i>	Flowering Raspberry	2 Gal.	\$35.00	○-◐	Average
<i>Salix discolor</i>	Pussy Willow	1 Gal. 3 Gal.	\$25.00 \$55.00	○-◐	Moist to Average
<i>Salix eriocephala</i>	Diamond Willow	1 Gal.	\$25.00	○	Moist
<i>Salix lucida</i>	Shining Willow	1 Gal.	\$25.00	○-◐	Moist
<i>Salix sericea</i>	Silky Willow	1 Gal.	\$25.00	○-◐	Moist
<i>Sambucus nigra</i> spp. <i>canadensis</i>	Elderberry	1 Gal. 3 Gal.	\$25.00 \$40.00	○-◐	Moist to Average
<i>Sambucus racemosa</i>	Red-berried Elderberry	1 Gal. 3 Gal.	\$25.00 \$40.00	○-◐	Average to Dry
<i>Sassafras albidum</i>	Sassafras	Call for Size		○-◐	Average to Dry
<i>Sorbus americana</i>	American Mountain Ash	1 Gal.	\$25.00	○-◐	Average to Dry
<i>Spiraea alba (latifolia)</i>	Meadowsweet	1 Gal.	\$25.00	○	Average to Dry
<i>Spiraea tomentosa</i>	Steeplebush	1 Gal.	\$25.00 \$55.00	○	Moist to Average
<i>Staphylea trifolia</i>	Bladdernut	1 Gal.	\$25.00 \$55.00	◐	Moist to Average

Trees/Shrubs/Vines*Light Exposure:* ○ - Full Sun, ◐ - Part Sun/Part Shade, ● - Full Shade

Latin	Common	Size	Price	Light Exposure	Soil Moisture
<i>Swida (Cornus) alternifolia</i>	Pagoda Dogwood	1 Gal. 3 Gal.	\$35.00 \$55.00	◐-●	Moist to Average
<i>Swida (Cornus) amomum</i>	Silky Dogwood	1 Gal. 3 Gal.	\$25.00 \$40.00	○-◐	Moist to Average
<i>Swida (Cornus) racemosa</i>	Gray Dogwood	1 Gal. 3 Gal.	\$25.00 \$40.00	○-◐	Moist to Average
<i>Swida (Cornus) sericea</i>	Red Twig Dogwood	1 Gal. 3 Gal.	\$25.00 \$45.00	○-◐	Moist to Average
<i>Taxus canadensis</i>	American Yew	1 Gal.	\$20.00	◐-●	Average
<i>Vaccinium angustifolium</i>	Lowbush Blueberry	1 Gal.	\$35.00	○-◐	Moist to Dry
<i>Vaccinium corymbosum</i>	Highbush Blueberry	1 Gal. 3 Gal.	\$25.00 \$55.00	○-◐	Moist to Average
<i>Vaccinium macrocarpon</i>	Large Cranberry	1 Qt.	\$10.00	○	Moist
<i>Viburnum acerifolium</i>	Mapleleaf Viburnum	1 Gal.	\$25.00	◐	Average to Dry
<i>Viburnum dentatum</i>	Arrowwood Viburnum	1 Gal. 3 Gal.	\$25.00 \$50.00	○-◐	Moist to Average
<i>Viburnum lantanoides</i>	Hobblebush	1 Gal.	\$35.00	◐-●	Moist to Average
<i>Viburnum lentago</i>	Nannyberry	1 Gal. 3 Gal.	\$25.00 \$45.00	○-◐	Moist to Average

Trees/Shrubs/Vines

Light Exposure: ○ - Full Sun, ◐ - Part Sun/Part Shade, ● - Full Shade

Latin	Common	Size	Price	Light Exposure	Soil Moisture
<i>Viburnum nudum var. cassinoides</i>	Witherod	1 Gal. 3 Gal.	\$25.00 \$45.00	◐	Moist to Average
<i>Viburnum opulus (trilobum)</i>	American Cranberry Bush	1 Gal. 3 Gal.	\$25.00 \$50.00	○-◐	Moist to Average
<i>Viburnum prunifolium</i>	Blackhawk Viburnum	1 Gal. 7 Gal.	\$30.00 \$95.00	◐-○	Moist to Dry
<i>Vitis aestivalis</i>	Summer Grape	1 Gal.	\$20.00	○-◐	Average to Dry
<i>Vitis labrusca</i>	Fox Grape	1 Gal.	\$20.00	○-◐	Moist to Average
<i>Vitis riparia</i>	River Grape	1 Gal.	\$20.00	◐	Moist to Average

Notes

